



Installation Instructions for LDEF130-RH Landrover Defender 130 Dual Cab 70L Auxiliary Tank

This auxiliary tank fits on the RH side of the vehicle between the front and rear axle. The system operates via a fuel transfer system whereby the fuel is pumped from the auxiliary tank into the main tank at the flick of a switch. The tank is fitted with a fuel level sender unit. Fuel is transferred via an electric pump that will pump fuel from the auxiliary tank into the OEM tank. A combination switch/gauge will be located into a suitable blank in the dash. When the switch is in operation an **ORANGE** light will be ON, indicating that the transfer pump is in operation. A series of lights will also indicate fuel level. All **GREEN** lights on showing FULL, one **RED** flashing light showing EMPTY.

**(DO NOT OPERATE TRANSFER PUMP WITH NO FUEL IN AUXILIARY TANK OR
PUMP FAILURE WILL OCCUR).**

1. Run twin core cable from under vehicle to inside cab and carry out wiring as per wiring diagram.
2. Screw all fittings and fuel level sender into auxiliary tank as per diagram. Except for P3 1/2 x 1/4 hose barb straight which should be fitted after tank is installed.
3. Fit tank-mounting brackets to front and rear chassis out riggers. These brackets locate to original holes in the chassis out riggers. The front bracket on the tank sits on the topside of the secondary bracket.
4. Lift tank into position - remember to connect sender unit wire - check clearances, drill remaining holes and bolt tank into position. **NOTE:** when drilling hole for centre inside mount be careful there is a wiring loom inside the chassis rail.
5. Fit filler neck to vehicle in short 1/4 panel section just behind rear driver's side door. Using 67mm hole saw, cut holes in 1/4 panel and floor to fit grommets for fill pipe. **NOTE:** the hole in the floor for the filler needs to be in line with the filler neck on the tank. Use a 25mm hole saw to cut hole for the fast fill vent line grommet.

6. Connect fill pipe to filler neck and tank, fit fuel transfer pump and filter, complete remaining connection of fuel lines and wiring.
7. Fill with fuel and check fuel transfer pump operation.



FITTING KIT CONTENTS LDEF130-RH

Updated 7/22 TL

Brass:	Electrical:
<ul style="list-style-type: none"> ○ 1 x P6 1/2 x 1/4 12mm Elbow for Fast Fill Vent on Filler ○ 1 x P3 1/2 x 1/4 12mm Straight ○ 2 x P3 3/8 x 1/4 10mm Straight ○ 1 x P3 5/16 x 1/4 8mm Straight ○ 1 x 38mm Fill Pipe @ 300mm with 90° Bend <p><u>TD5 Add:</u></p> <ul style="list-style-type: none"> ○ 1 x 19 x 8mm T-piece 	<ul style="list-style-type: none"> ○ 1 x Two Core Wire @ 4000mm ○ 1 x LRA-PG210 Switch/Gauge & Loom ○ 2 x Red Insulated Terminals ○ 2 x Red Male Terminals ○ 3 x 6mm Earth Eye ○ 1 x Fuse ○ 1 x Fuse Holder ○ Terminals
Bolts / Nuts:	Misc Parts:
<ul style="list-style-type: none"> ○ 8 x M10 x 30mm Bolts ○ 2 x M8 x 25mm Bolts ○ 8 x M10 Nyloc Nuts ○ 2 x M8 Nyloc Nuts ○ 8 x M10 Washers ○ 2 x M8 Washers ○ 1 x M8 x 100 Bolt 	<ul style="list-style-type: none"> ○ 1 x Filler Pipe #FNLD (RH or LH) ○ 1 x SL111D Diesel Locking Cap ○ 2 x 85 x 50 Grommet ○ 1 x WG11 Grommet (for Fast Fill Vent) ○ 3 Secondary Brackets
Hose Clamps:	Cable Ties:
<ul style="list-style-type: none"> ○ 8 x 1/4" Hose Clamps ○ 2 x 1/2" Hose Clamps ○ 4 x 1 1/2" Hose Clamps <p><u>TD5 Add:</u></p> <ul style="list-style-type: none"> ○ 2 x 5/8" Hose Clamps 	<ul style="list-style-type: none"> ○ 10 x 7" Cable Ties ○ 5 x 11" Cable Ties
Sender:	Pumps & Filters:
<ul style="list-style-type: none"> ○ 1 x 0-90 OHM c/w 400mm Earth Lead Soldered On 	<ul style="list-style-type: none"> ○ 1 x Fuel Pump ○ 1 x Fuel Pump Mounting Plate

Hose:	6 Pages of Fitting Instructions Consisting of:
<ul style="list-style-type: none"> ○ 1 x 38mm Hose @ 200mm ○ 1 x 38mm Hose @ 300mm ○ 1 x 12mm CMP Hose @ 950mm ○ 1 x 10mm Fuel Hose @ 450mm ○ 1 x 8mm Fuel Hose @ 1600mm <p><u>TD5 Add:</u></p> <ul style="list-style-type: none"> ○ 1 x 8mm Fuel Hose @ 500mm 	<ul style="list-style-type: none"> ○ 2 x Pages Fitting Instructions ○ 2 x Pages Kit Contents ○ 1 x Page WDSGPG210 Diagram ○ 1 x Page INLDEF130 Diagram

Kit Packed By_____

Checked By _____

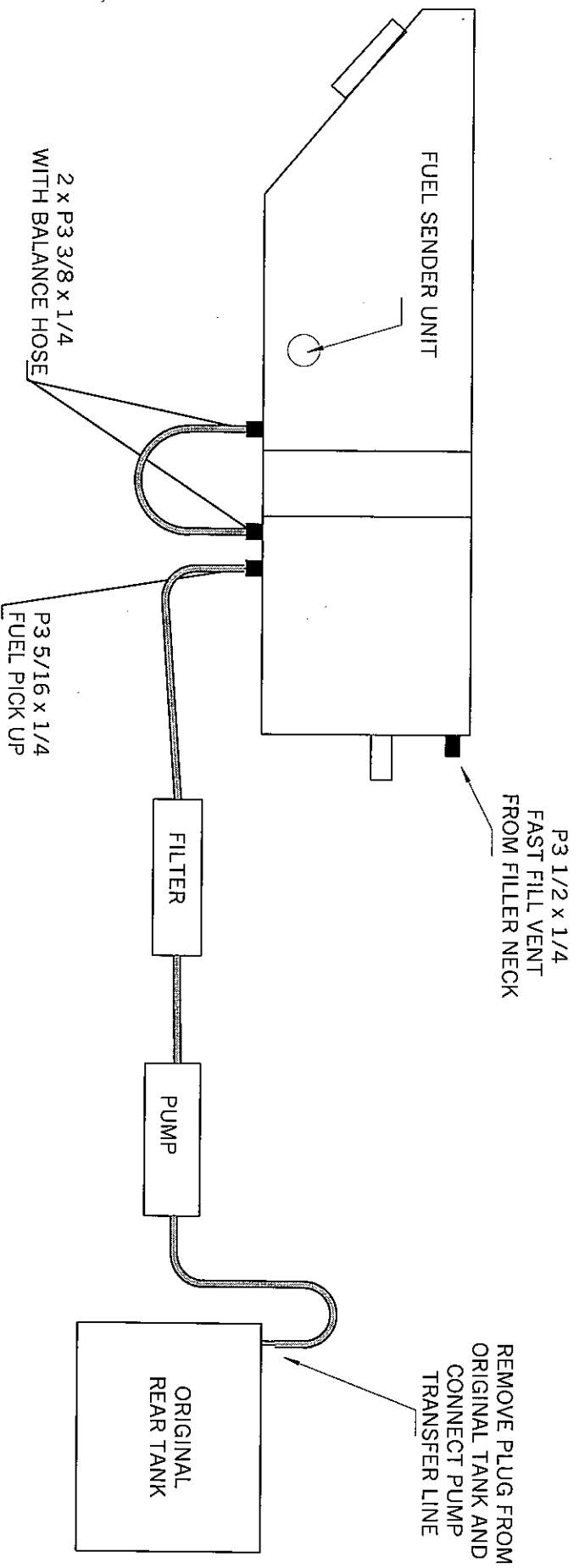

FILLER LOCATION

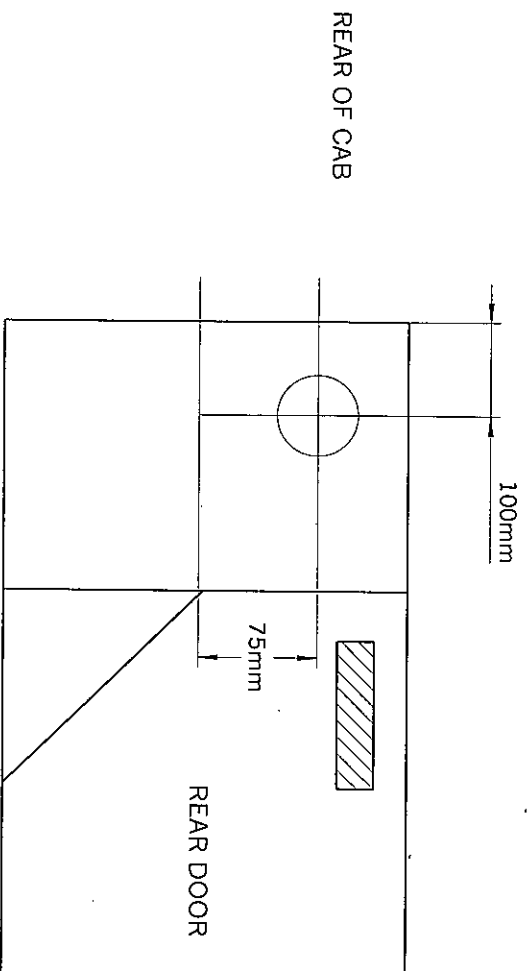

INLDEF130
LANDROVER DEF 130
70 LT AUX TANK

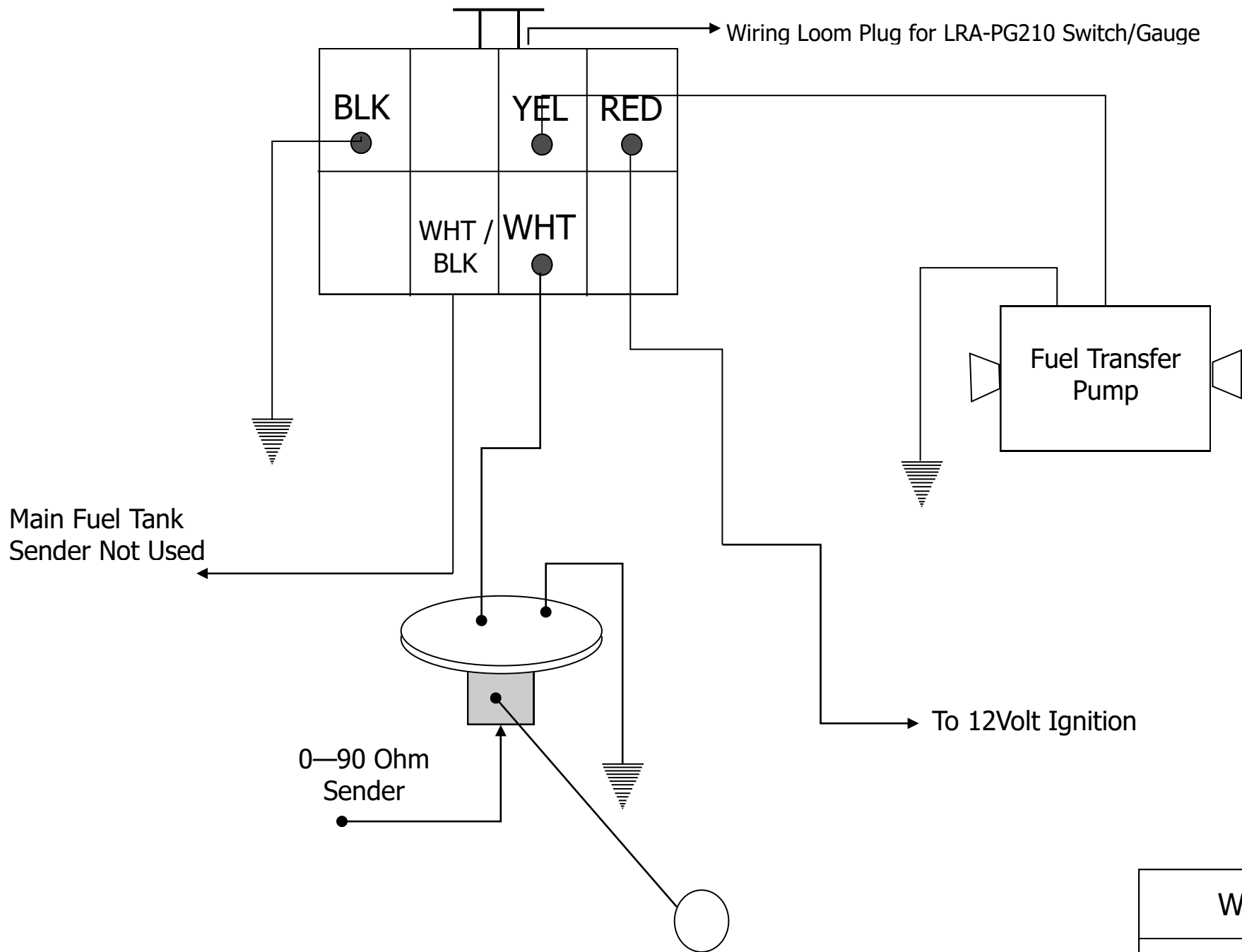

WDSGPG210