



## **Installation Instructions for LD3AMY08** **Land Rover Discovery Series III / IV** **108lt Auxiliary Tank**

This Auxiliary tank fits under the rear of the vehicle and takes the place of the spare wheel. Fuel is transferred via an electric pump that will pump fuel from the auxiliary tank into the OEM tank. A combination switch/gauge will be located into a suitable position in the dash. When the switch is in operation an **ORANGE** light will be ON, indicating the transfer pump is in operation. A series of lights will also indicate fuel level. All **GREEN** lights on showing FULL, one **RED** flashing light showing EMPTY.

Once the auxiliary tank is empty the pump will automatically shut off after 2 minutes.

1. Select a suitable place in the dash to mount the switch/gauge unit. There are limited options for this, however, we suggest placing it in the soft part of the dash on the tacho side. Complete the wiring as per diagram and run the twin core sheathed cable to the rear of the vehicle.
2. Remove the spare wheel and unbolt the wheel winch. Remove the RHR wheel, and the inner wheel arch cover. From the centre of the 45deg bend on the STD filler neck, mark a point 110mm down the fill pipe and cut with a chain pipe cutter, refer diagram. Disconnect fast fill and vent lines and remove STD filler neck.
3. Install the rear secondary brackets using M12 x 30mm bolts with strap attached, Nyloc nuts and washers.
4. Bolt the front secondary bracket in between the chassis and exhaust cover, then enlarge the existing holes in the cover to clear the bolt head on the secondary bracket. Re-drill 2 M8 holes in cover to fix cover back to secondary bracket using the fuel pump mounting bracket, M5x20mm counter sunk screws and nuts. Mount the fuel transfer pump to the bracket and bolt the pump to the hole which is up inside the top of the RHR shock absorber mount. Use the M8 bolt that has the strap attached to accomplish this.

5. Install fittings in the tank as per drawing and fit 1400mm length of 6mm hose to the P6 1/4x 1/8 elbow and the 950mm length of 16mm hose to the P6 5/8 x 1/4 elbow on the tank. Lift the tank into position, being careful not to trap any of the hoses in between the top of the tank and the chassis. Bolt in place with M10 fine thread nyloc nuts, washers and M10x25mm fine thread bolts with straps attached.
6. Assemble fittings in twin filler as per diagram. Slip the 90mm length of 35mm hose on the main tank branch of the twin filler and bolt filler in place. Connect the fill pipe from the twin filler to the auxiliary tank with 2 x 100mm lengths of 38mm hose. Connect the 16mm fast fill vent from the auxiliary tank to the 16mm elbow on the back of the twin filler and the original main tank fast fill vent to the 16mm elbow on the front side of the twin filler. The 1400mm length of 6mm hose previously connected to the auxiliary tank goes to the 6mm elbow on the top of the twin filler. Connect the 8mm fuel pick up to the in-line filter then to inlet side of the transfer pump and the outlet side of pump to the remaining 8mm elbow in the twin filler.
7. Complete wiring of the transfer pump and sender unit. Neatly cable tie all hoses and wiring, check operation and refit inner wheel arch cover.



## FITTING KIT CONTENTS LD3AMY08

Updated 29/4 TL

Brass:	Electrical:
<ul style="list-style-type: none"> <li>○ 1 x P3 5/16 x 1/4 Straight</li> <li>○ 1 x P6 5/16 x 1/4 Elbow</li> <li>○ 3 x P6 5/8 x 1/4 Elbows</li> <li>○ 2 x P6 1/4 x 1/8 Elbows</li> </ul>	<ul style="list-style-type: none"> <li>○ 1 x LRA-PG210 Switch Gauge</li> <li>○ 1 x 3mm 2 Core Wire 5.5m Long</li> <li>○ 1 x 4mm Single Core Blue Wire @300mm</li> <li>○ 1 x 5AMP Fuse</li> <li>○ 1 x Fuse Holder</li> <li>○ 2 x Fuse Holder Terminals</li> <li>○ 2 x Red Terminals</li> <li>○ 1 x Red Eye Terminal 5mm</li> <li>○ 1 x Blue Eye Terminal 8mm</li> <li>○ 1 x Red Male Terminal</li> <li>○ 2 x Shrink Tube @ 35mm</li> </ul>
Bolts / Nuts:	Misc Parts:
<ul style="list-style-type: none"> <li>○ 2 x M8 x 20 Bolts</li> <li>○ 2 x M8 x 25 Flat Washers</li> <li>○ 2 x M8 Spring Washers</li> <li>○ 8 x M10 x 25 Flat Washers</li> <li>○ 1 x M8 Nyloc Nut</li> <li>○ 6 x M10 Fine Thread Nyloc Nuts</li> <li>○ 2 x M5 Washers</li> <li>○ 1 x M8 x 20 Flat Washers</li> <li>○ 2 x M5 x 20 Counter Sunk Screws</li> <li>○ 2 x M5 Nuts</li> <li>○ 4 x M12 Heavy Duty Washers</li> <li>○ 2 x M12 Nyloc Nuts</li> </ul>	<ul style="list-style-type: none"> <li>○ 1 x Twin Filler #TFLD3A</li> <li>○ 1 x Fill Pipe #FPLD3A</li> <li>○ 1 x Non-Locking Cap</li> <li>○ 1 x Front Secondary Bracket</li> <li>○ 2 x LD3AMY08 Rear Secondary Brackets with M10 x 30mm Fine Thread Bolts (LH &amp; RH)</li> <li>○ 1 x M8 x 20 Bolt on 170mm Strap</li> <li>○ 2 x M10 x 25 Fine Thread Bolts on 150mm Strap</li> <li>○ 2 x M12 x 30mm Bolts on 150mm Strap</li> </ul>
Hose Clamps:	Hose:
<ul style="list-style-type: none"> <li>○ 8 x 1/4 Hose Clamps</li> <li>○ 3 x 5/8 Hose Clamps</li> <li>○ 6 x 1 1/4" Hose Clamps</li> </ul>	<ul style="list-style-type: none"> <li>○ 1 x 8mm Hose @ 1100mm</li> <li>○ 1 x 35mm Hose @ 90mm</li> <li>○ 2 x 38mm Hose @ 100mm</li> <li>○ 1 x 6mm NTP Hose @ 1400mm</li> <li>○ 1 x 16mm NTP Hose @ 950mm</li> </ul>

<b>Pumps &amp; Filters:</b>	<b>Cable Ties:</b>
<ul style="list-style-type: none"> <li>○ 1 x Fuel Pump &amp; Filter</li> <li>○ 1 x Fuel Pump Mounting Plate</li> </ul>	<ul style="list-style-type: none"> <li>○ 10 x 7" Cable Ties</li> <li>○ 2 x 11" Cable Ties</li> </ul>
<b>Sender:</b>	<b>8 Pages of Fitting Instructions Consisting of:</b>
<ul style="list-style-type: none"> <li>○ 1 x Sender 0-90ohm C/W 800mm earth Installed With:</li> <li>- 5 x M5 x 10 Pan head Screw</li> <li>- 5 x M5 Spring Washers</li> </ul>	<ul style="list-style-type: none"> <li>○ 2 x Page Fitting Instructions</li> <li>○ 2 x Page Fitting Kit Contents</li> <li>○ 3 x Installation Diagrams</li> <li>○ 1 x Page WDSGPG210 Wiring Diagram</li> </ul>

Kit Packed By\_\_\_\_\_

Checked By \_\_\_\_\_

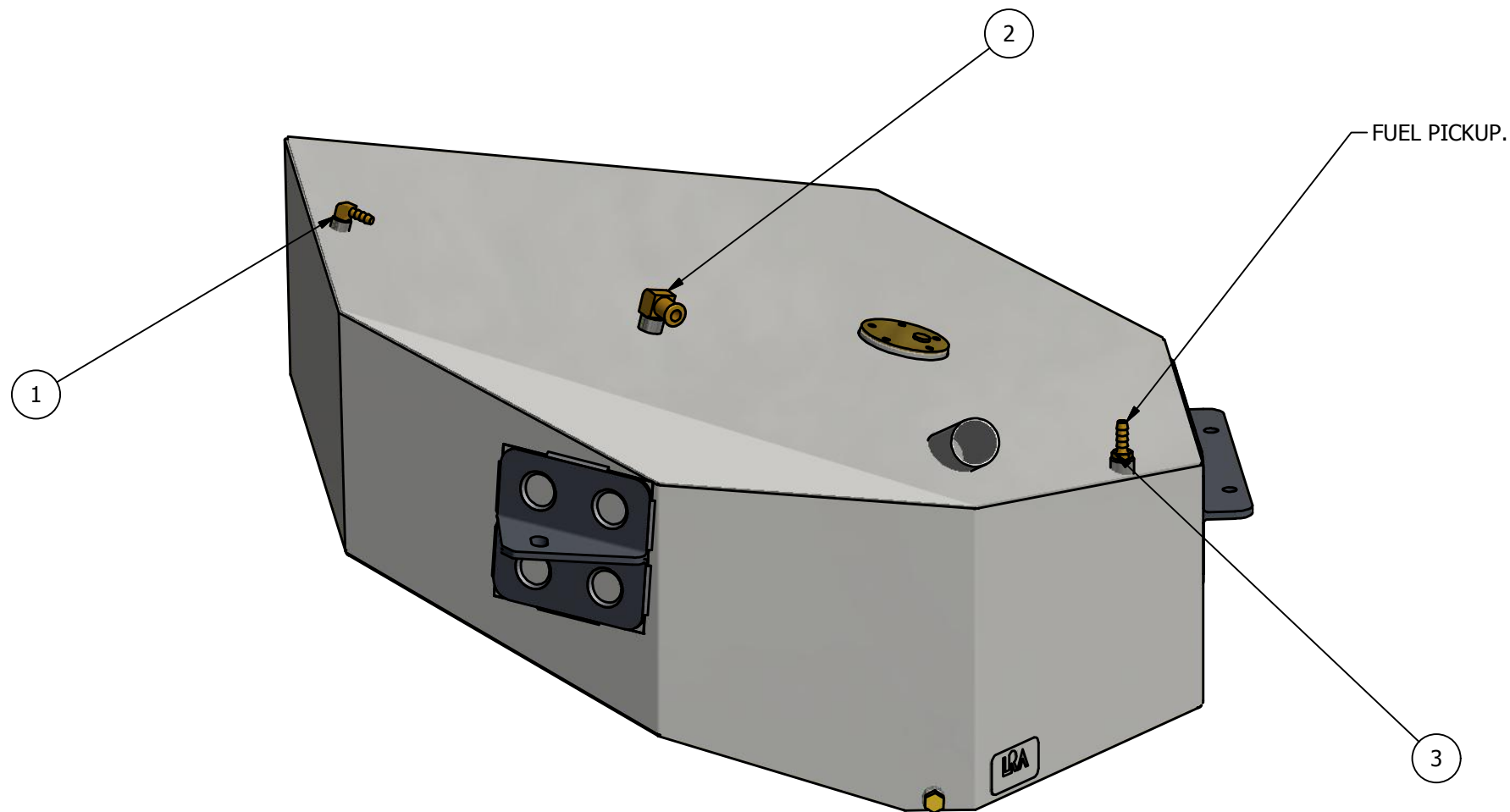

ITEM	QTY	DESCRIPTION
1	1	P6 1/4 x 1/8 elbow
2	1	P6 5/8 x 1/4 elbow
3	1	P3 5/16 x 1/4 straight

THIS DRAWING REMAINS THE PROPERTY OF  
LONG RANGE AUTOMOTIVE AND IS NOT TO BE DUPLICATED  
WITHOUT PERMISSION



LD3AMY08

INSTALLATION

Land Rover Discovery Series 3  
2008- 108ltr rear Aux.  
Brass fittings installiation.

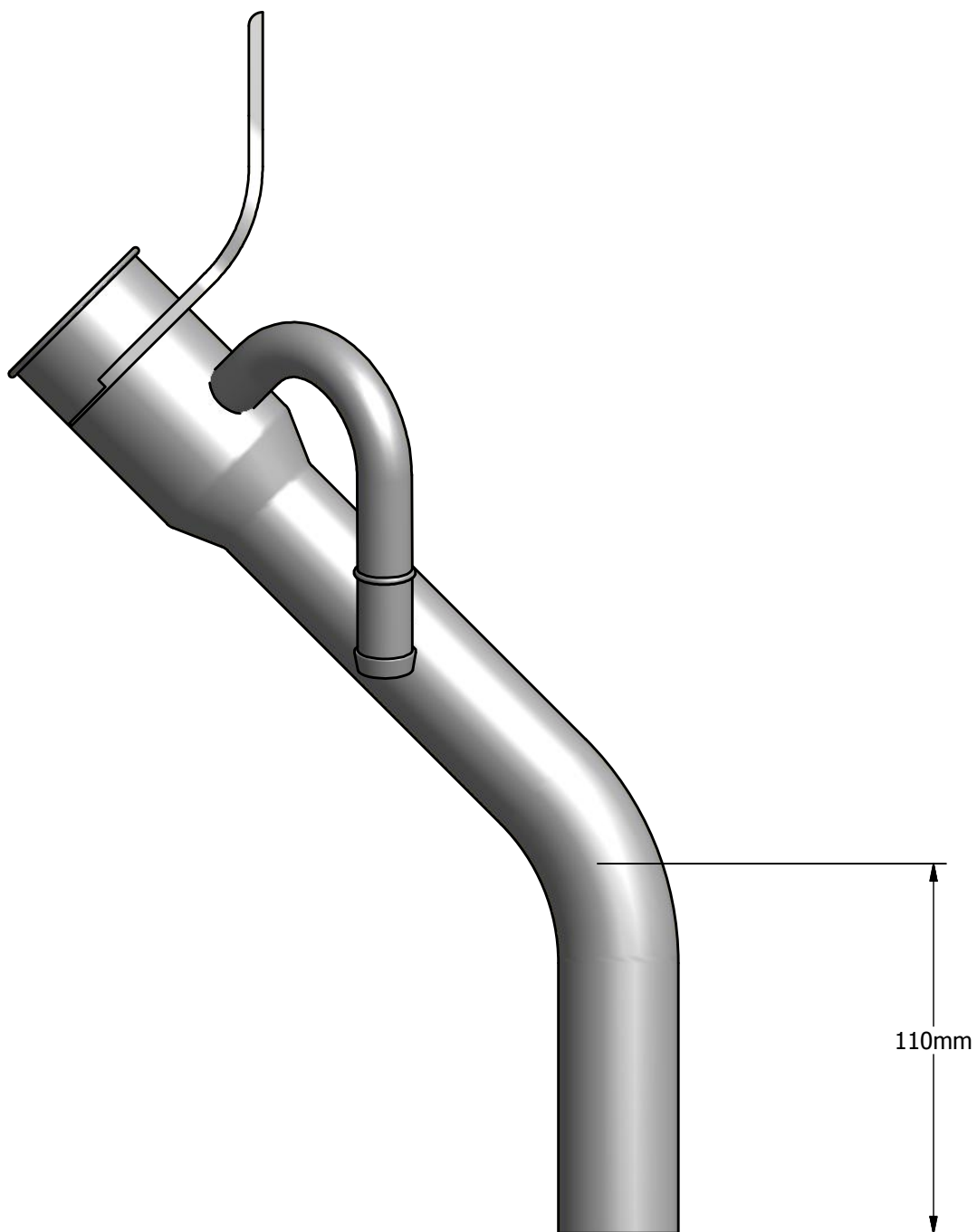

LD3AMY08

INSTALLATION

Land Rover Discovery series 3  
2008- 108ltr rear aux.  
Filler neck modifications.

THIS DRAWING REMAINS THE PROPERTY OF  
LONG RANGE AUTOMOTIVE AND IS NOT TO BE DUPLICATED  
WITHOUT PERMISSION

P6 5/8x1/4 elbow

P6 5/8x1/4 elbow

P6 1/4x1/8 elbow

P6 5/16x1/4 elbow



THIS DRAWING REMAINS THE PROPERTY OF  
LONG RANGE AUTOMOTIVE AND IS NOT TO BE DUPLICATED  
WITHOUT PERMISSION

LD3AMY08

INSTALLIATION

Land Rover Discovery Series 3  
2008- 108Ltr Rear Aux.  
Twin filler brass fittings installation.

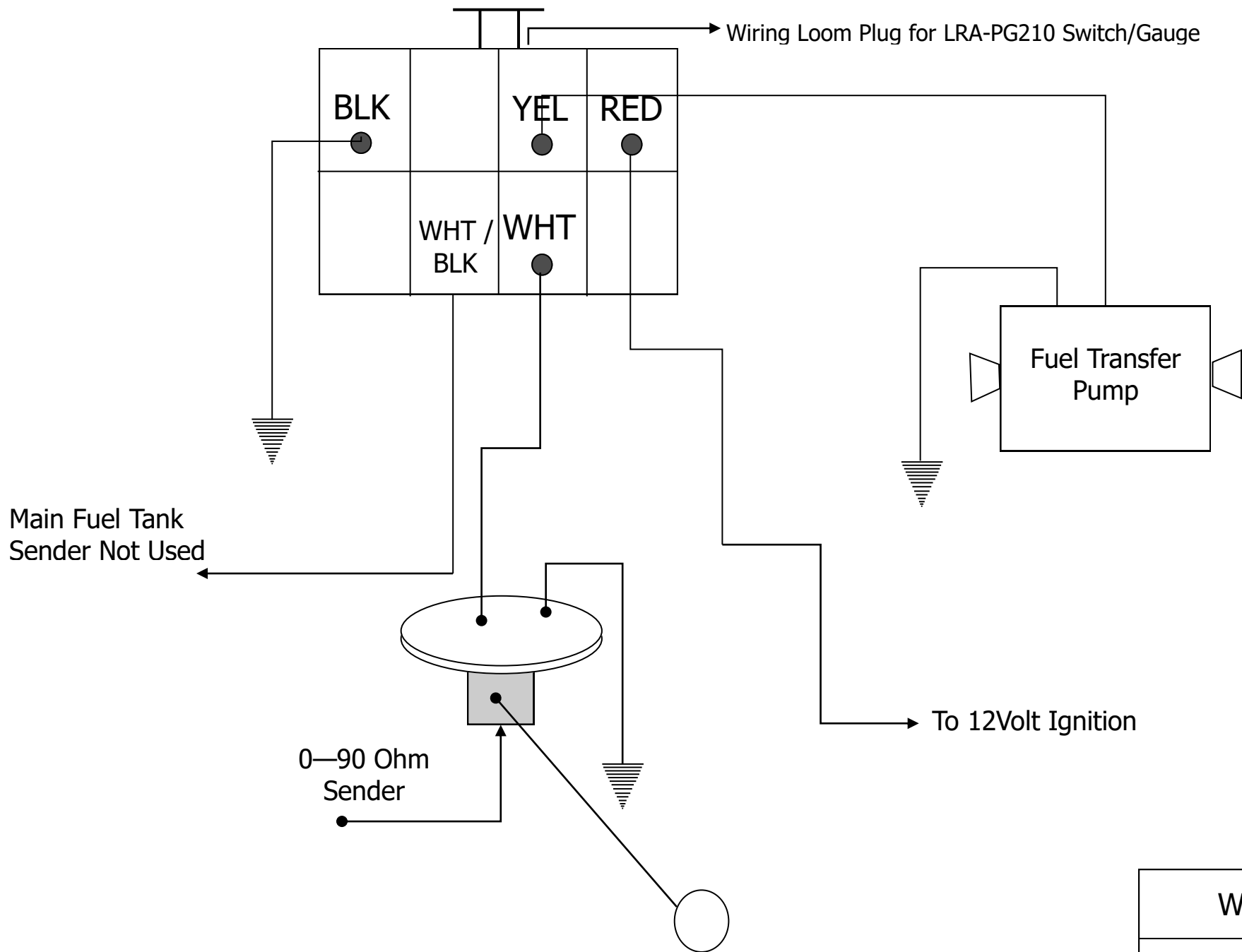

WDSGPG210